

'Wart' Warthog Paper Animation

'Wart' the A010 Warthog, 124FW IDANG

Engineered by Roblves.com

Redesigned by Michael Chamberlain, Msgt

2014-12-31-001

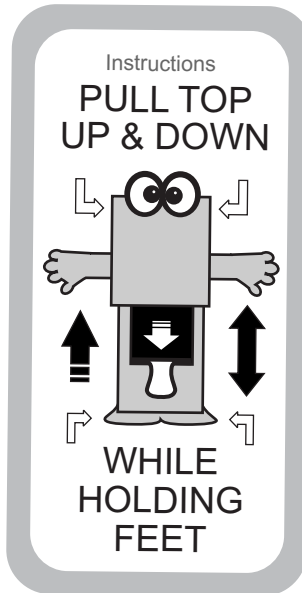

- Animation:
Arms raise,
Mouth opens,
Tongue extends.
- Print both sides of parts sheet on both sides of a single sheet of card stock.
- Score all dotted lines prior to cutting out and assembling to enable easy creasing.
- Use an Exacto-knife to cut all slots as well as those curves and hard-to-get-to cuts before separating parts.
- Cut on hard lines, fold on dotted lines, glue on shaded areas. Best way of gluing paper projects is to use white school glue and a plastic spreader.



* 'Wart' the A010 Warthog paper animation

- Part Sheet (font and back) is included at end of this document.

Recommended Tools:

- | | | | |
|------------------|-----------------|-------------------|-----------------------------|
| 1 - Ruler | 3 - Xacto Knife | 5 - Tweezers | 7 - White School Glue |
| 2 - Scoring Tool | 4 - Scissors | 6 - Glue Spreader | & Cutting Board (not shown) |

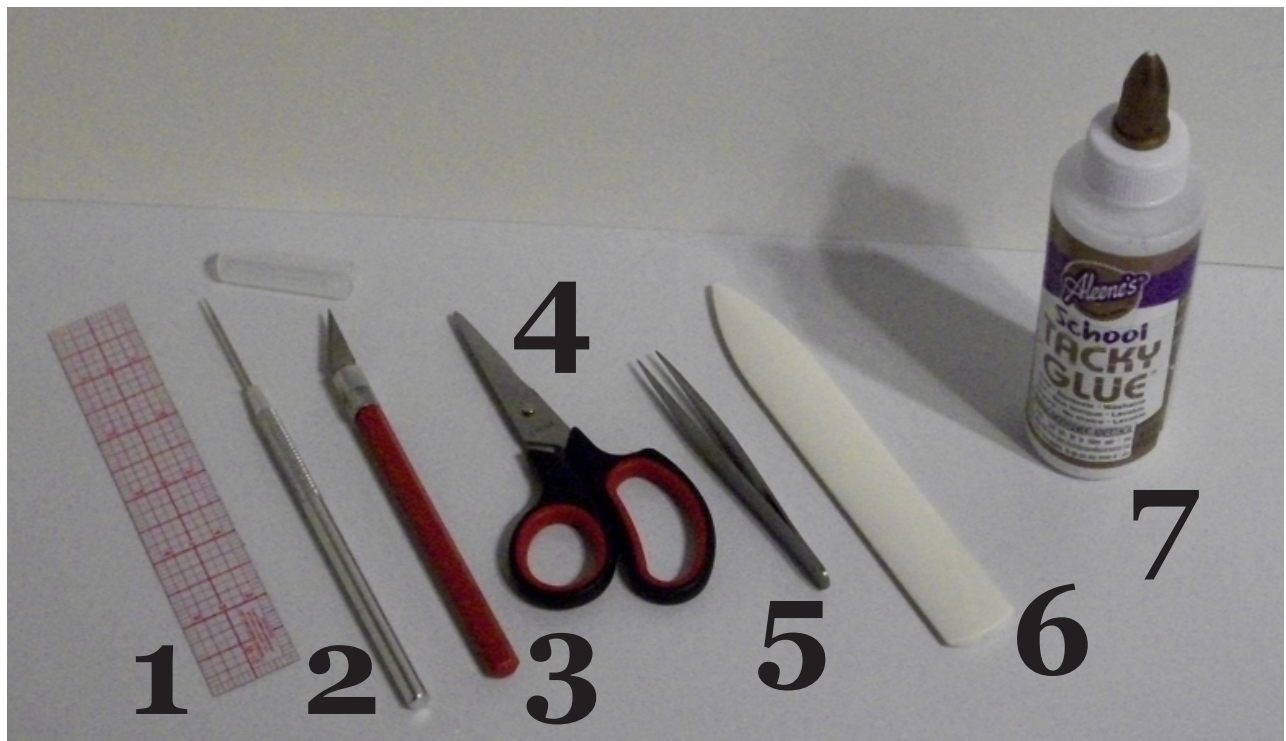

1. Print Parts

Print both sides of parts sheet on both sides of a single sheet of card stock.

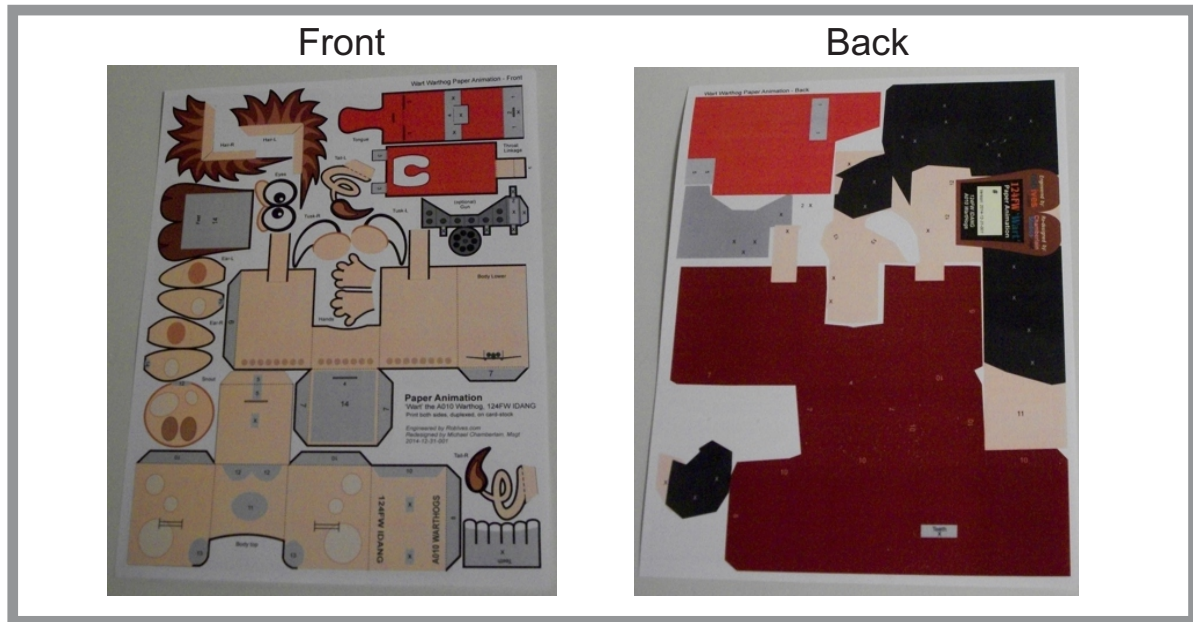

2. Score Folds

Score all dotted lines with a scoring tool to ease creasing during assembly. You can use a ruler and a clay-working tool, a single side of a pair of scissors, the point of a compass, or the back of a pocket knife; something sharp and pointed enough to score, but not cut through the page.

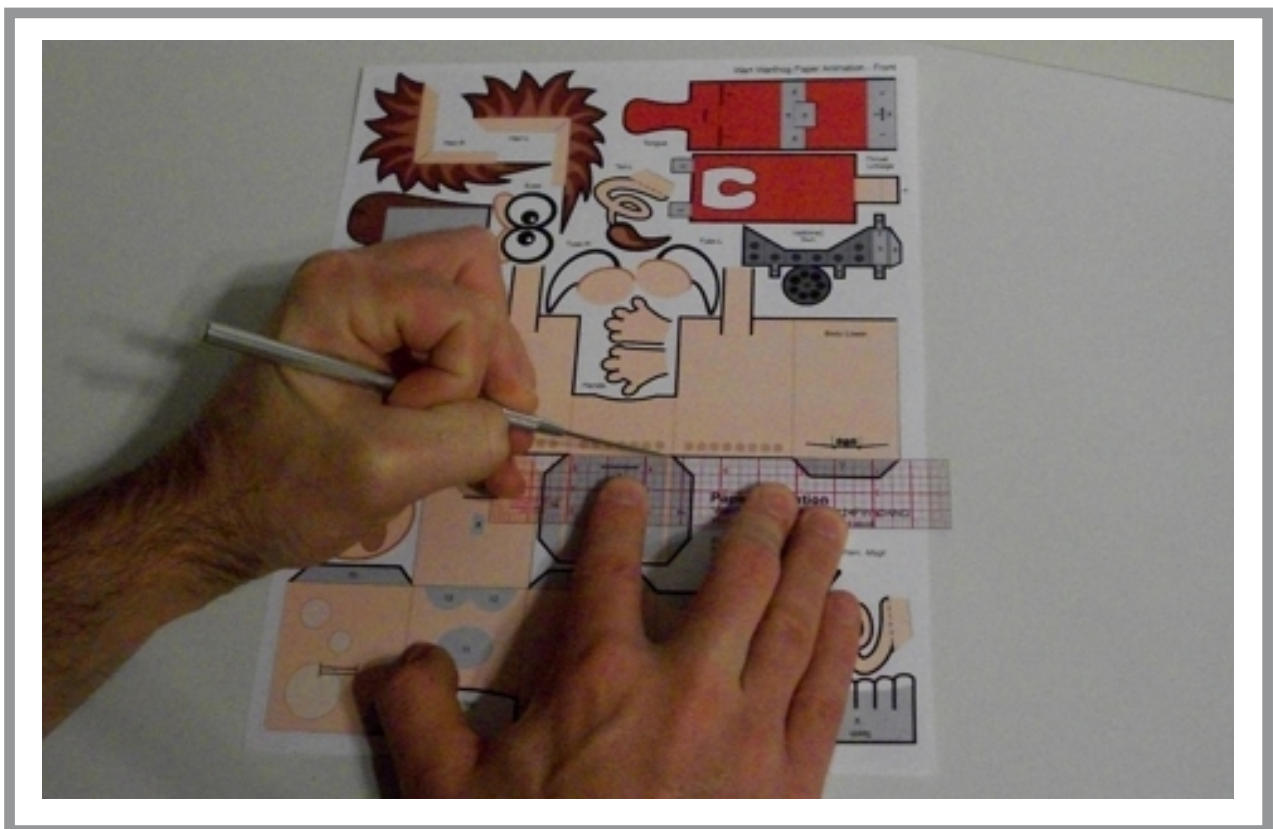

3. Xacto-Knife Interior Cuts & Separate Parts

Use an Xacto-Knife to cut out all slots and any curves or sections difficult to get to with scissors.

- The guide shown to the right highlights recommended areas to pre-cut with an Xacto-Knife while still in a full sheet.

Recommended Areas to Pre-Cut With Xacto-Knife Highlighted Yellow

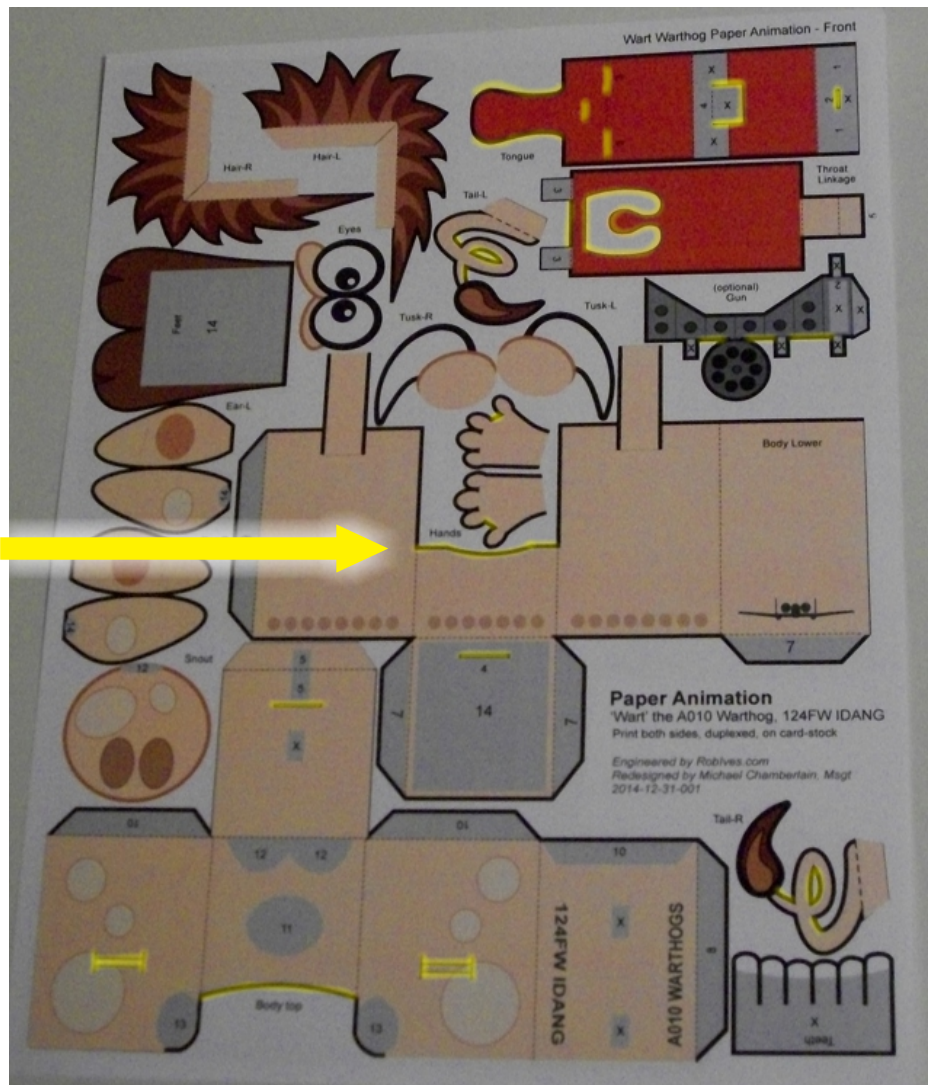

- Be sure to use a cutting board under your part sheet, so that you don't damage any table surfaces. And always be sure the cutting direction is away from your other hand and fingers, so they are not in danger of possible slips of the knife:

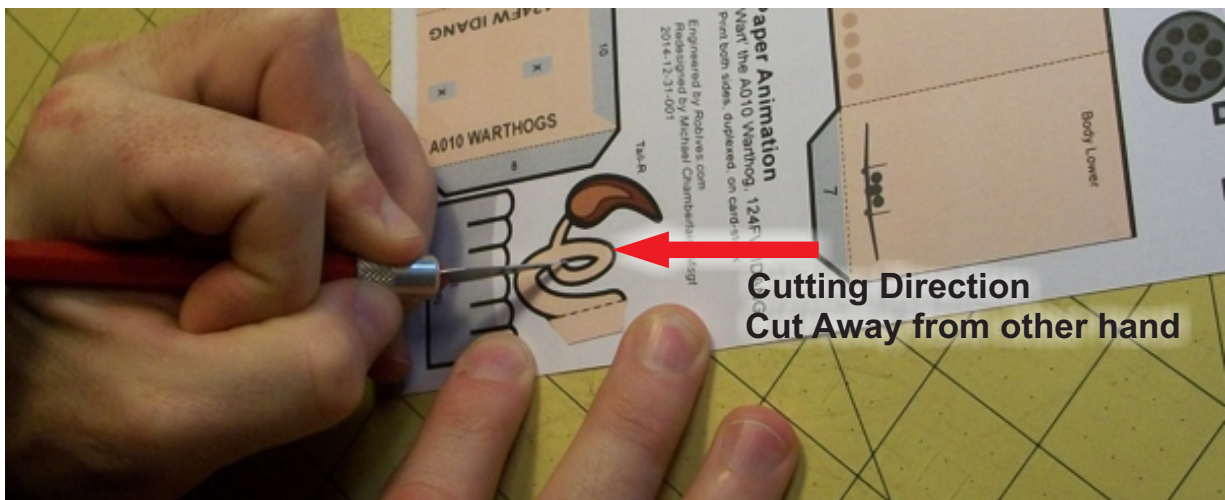

After pre-cutting all slots and other hard-to-cut areas, begin carefully separating parts with Xacto-knife. This makes final scissor-cutting easier:

- Begin separating parts with quick Xacto-knife cuts, again being careful to cut away from body parts.



- Continue separating all parts.

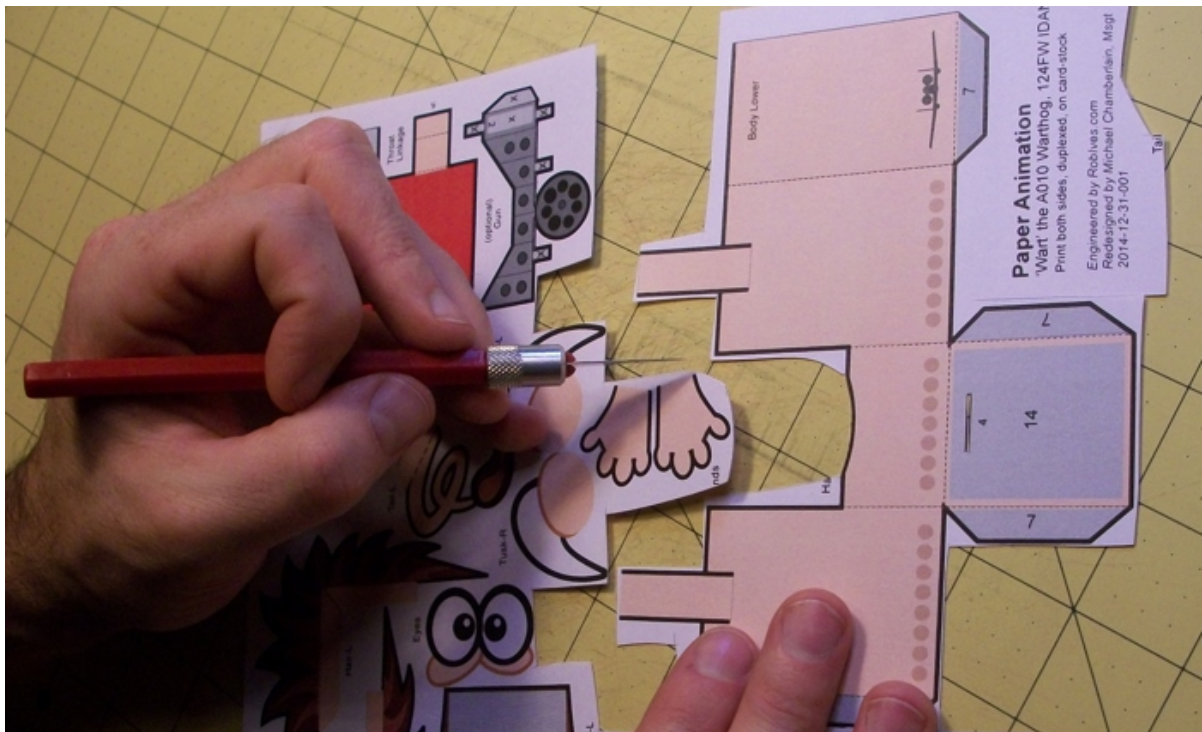

4. Completely Cut Out All Parts

Once all parts are separated, begin final-cutting all parts carefully with scissors.

- All parts roughly separated with Xacto-Knife can now be final-cut carefully with a good sharp pair of scissors:

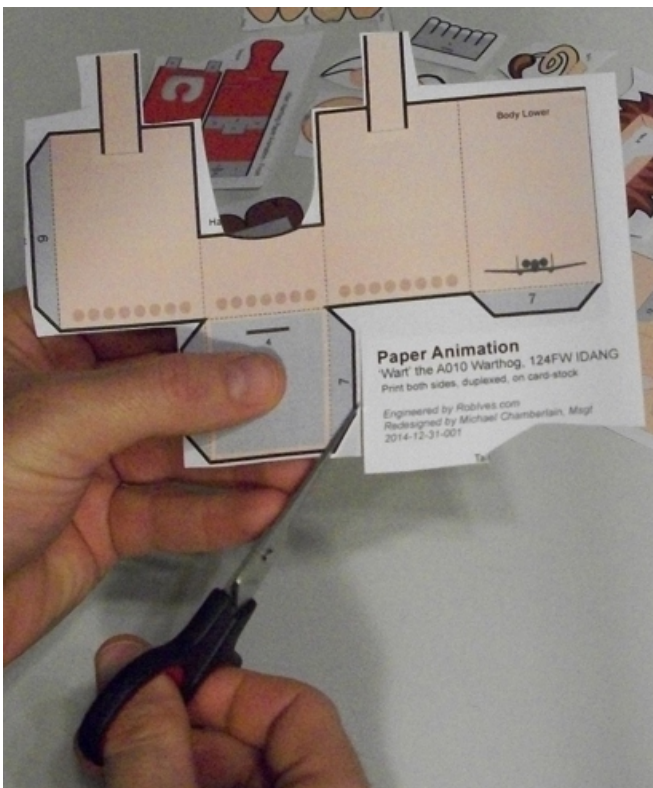
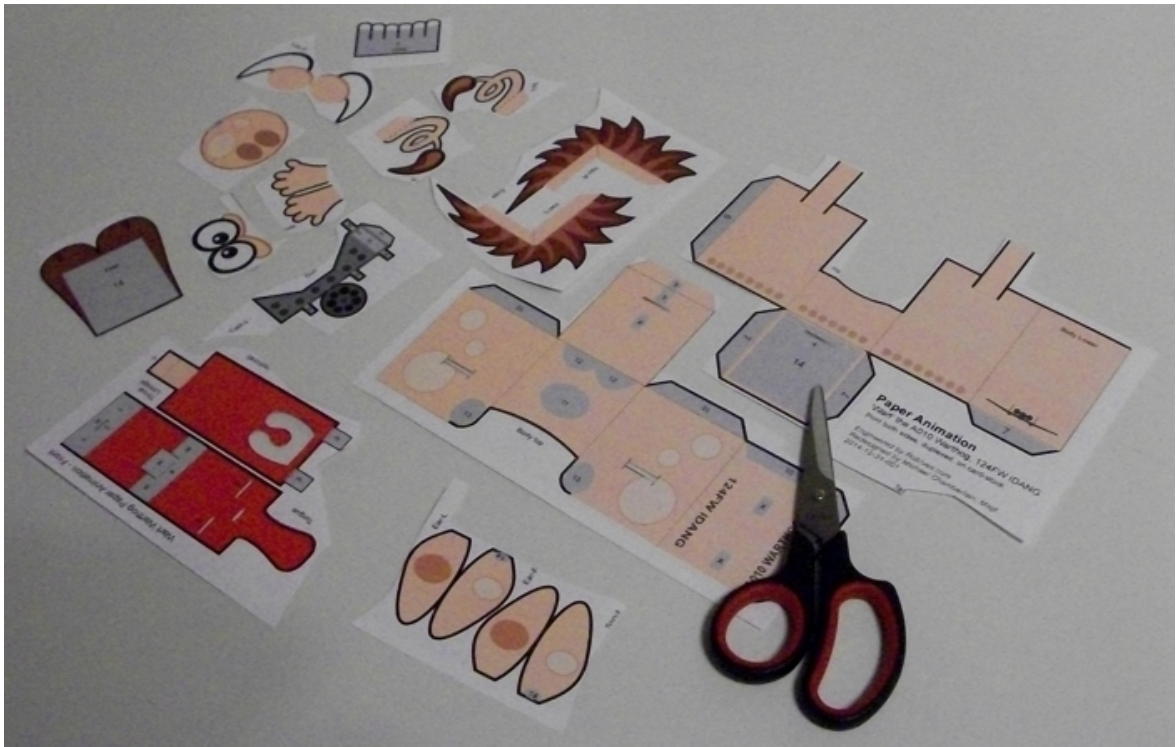

5. Assembly

Once all parts are carefully cut out, you can begin assembling.

- All parts carefully cut out with a good sharp pair of scissors, and ready for assembly:

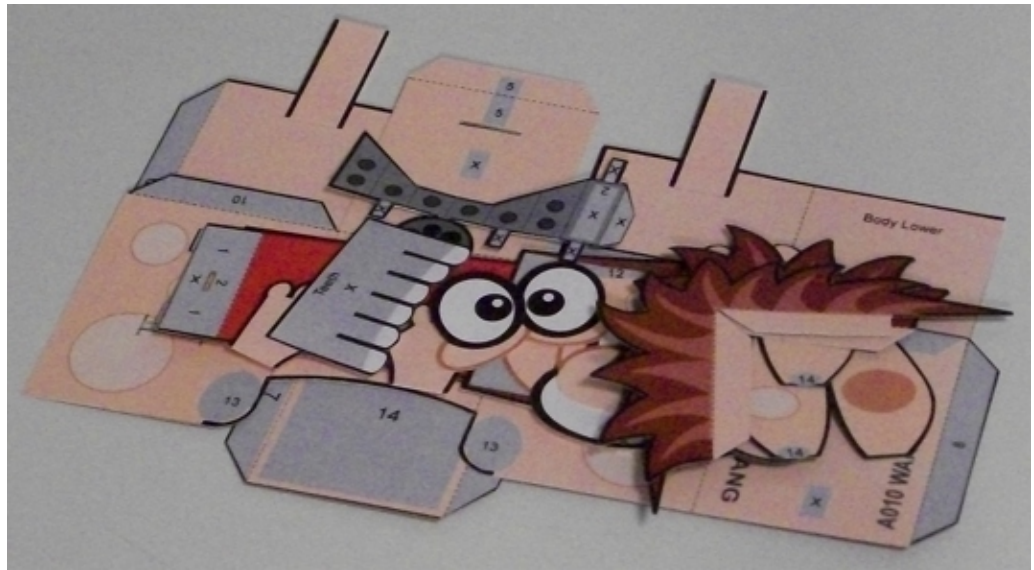

1

Assembly : 1 - Tongue



- Slightly bend all creases on each piece before assembling it.
- Apply glue to gray-colored surface of end of tongue.

Assembly : 1 - Tongue

Wrap and Glue Tongue assembly (gray area labeled #1).

1

- Spread glue to a thin skin with a glue spreader, then wrap and glue.

- Use tweezers to squeeze glued surfaces together.

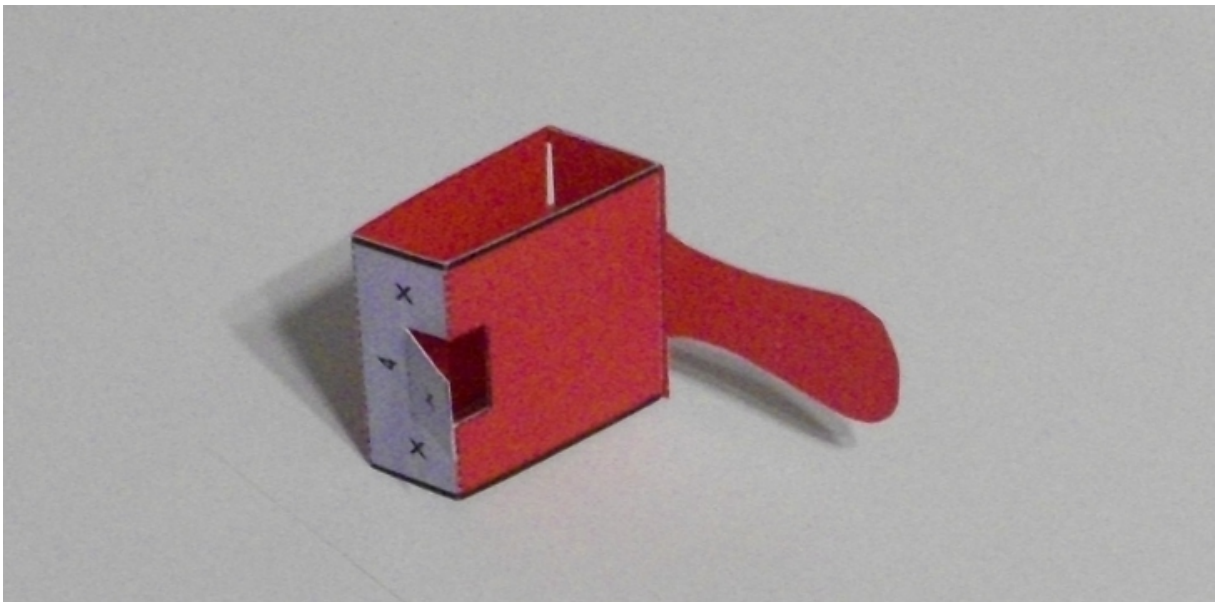
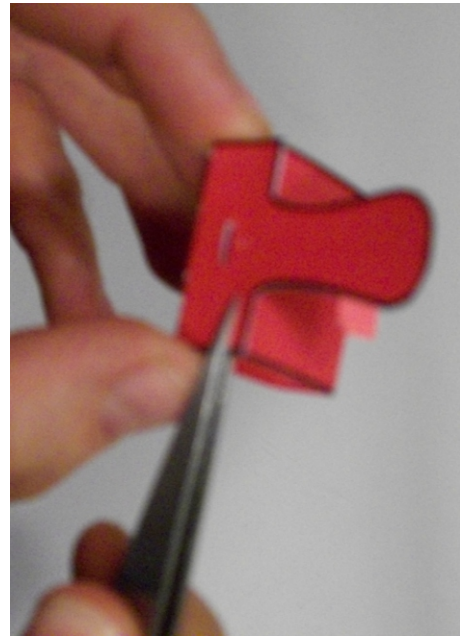
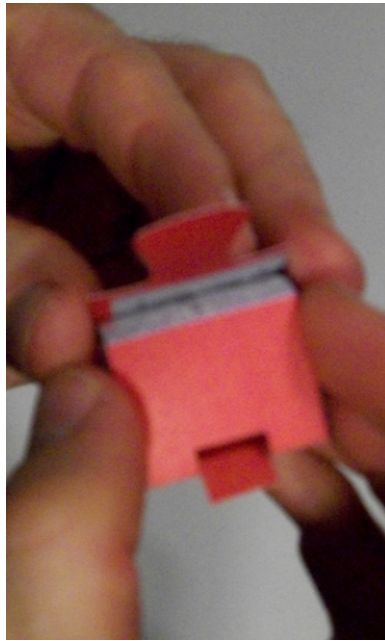

- Set completed tongue assembly aside.

Assembly : 2 - Gun (optional)

Crease, Glue, and Assemble Gun (if desired).

2

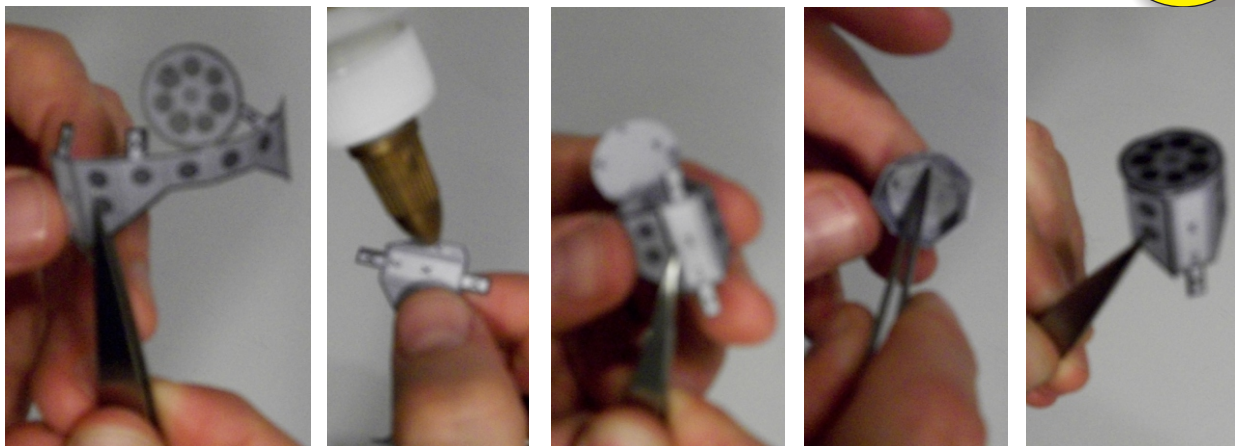

Glue Gun to top of Tongue (if desired), by threading tab (2) through slot (2) on top of Tongue.

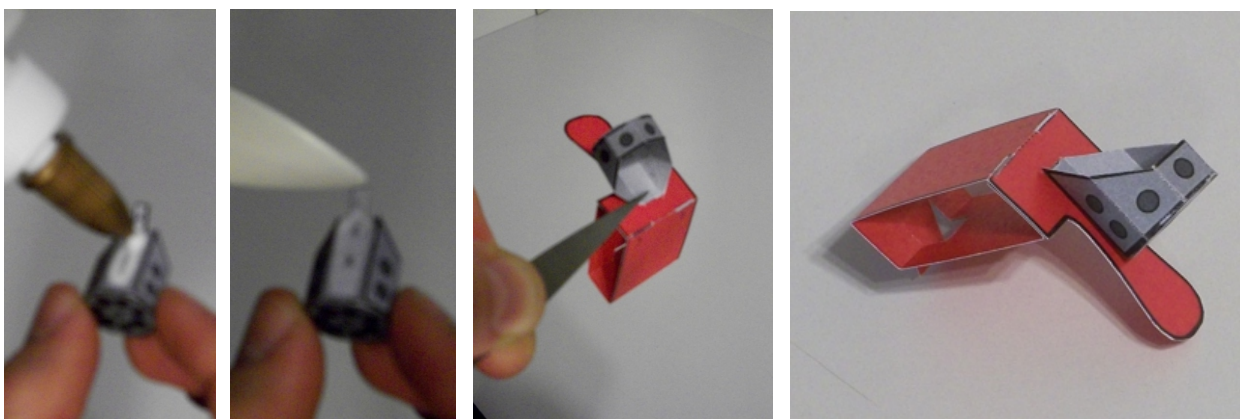

Assembly : 3 - Assemble Throat Linkage

Glue Throat assembly to back of Tongue assembly with tabs (3).

3

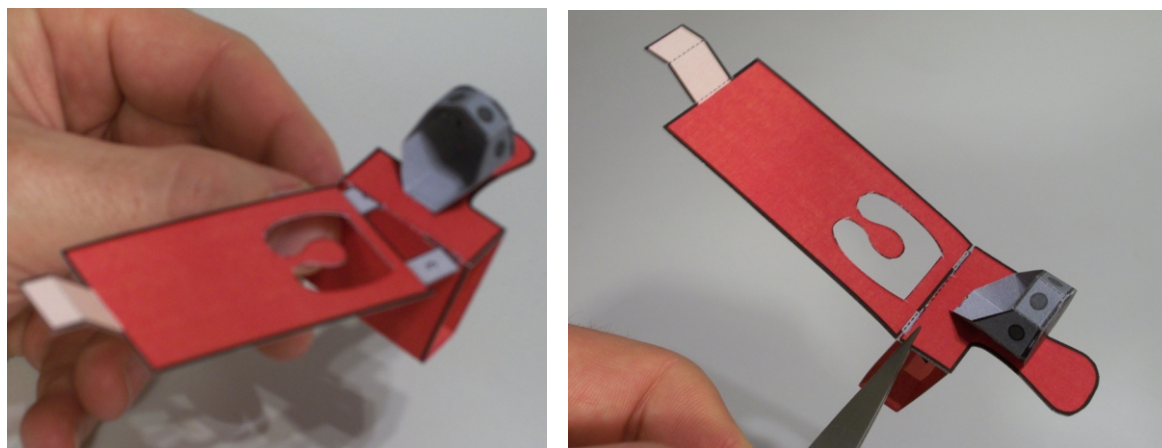

- Pinch glued tabs with Tweezers

Assembly : 4 - Tongue & Throat to Body-Bottom

Crease, Glue, and Assemble Tongue & Throat to Bottom of Body.

4

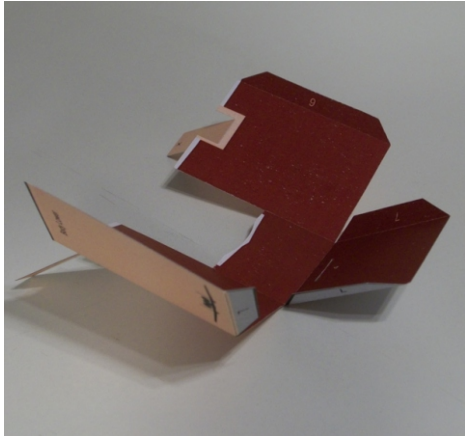

● Prepare Body-Bottom

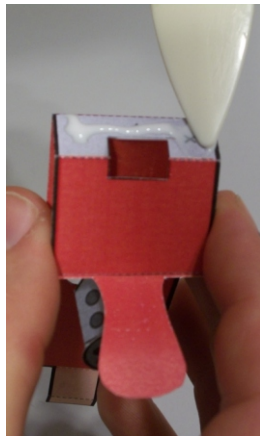

● Glue Bottom of Tongue

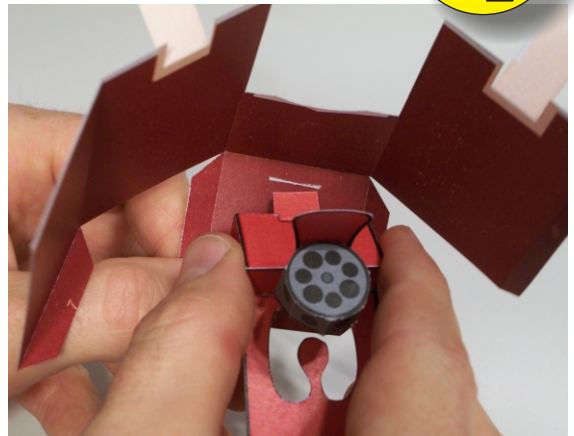

● Glue Tongue Assembly to Body-Bottom with Tab (4).

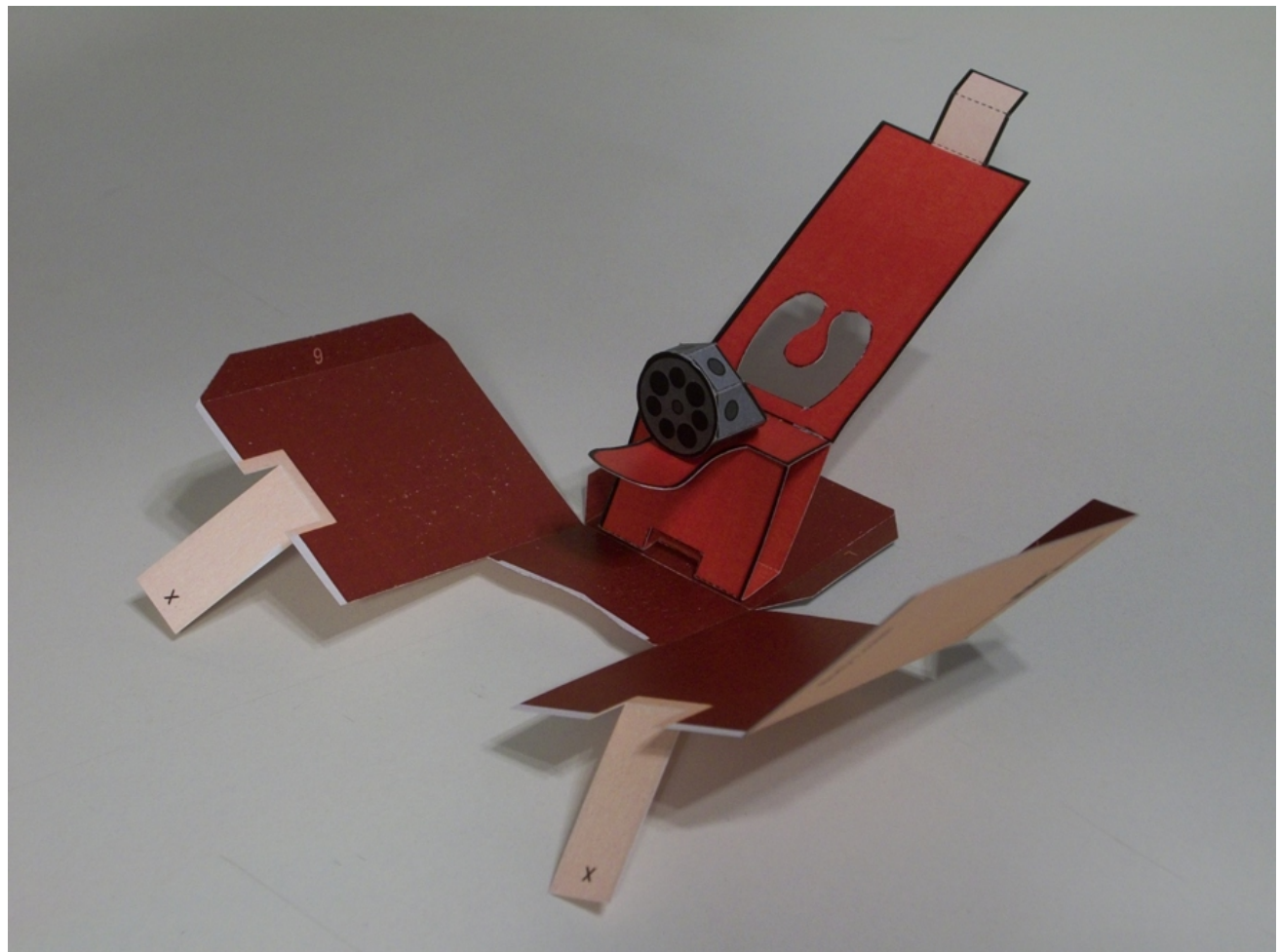

● Completed Assembly of Tongue & Throat Linkage to Body-Bottom.

Assembly : 5 - Wrap & Assemble Bottom of Body

Glue and Assemble Bottom of Body using Tabs 6 & 7.

5

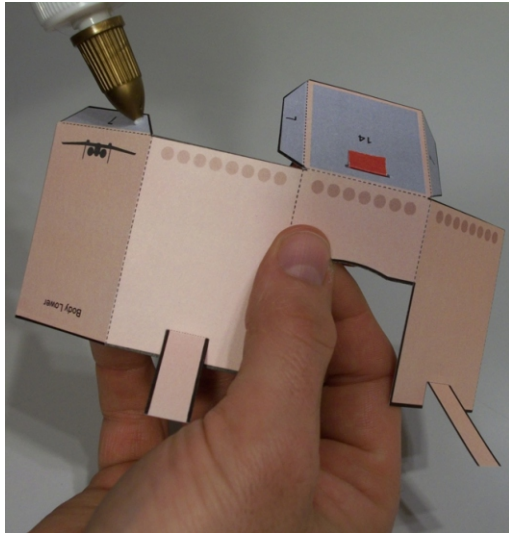

● Glue Tabs 6 & 7.

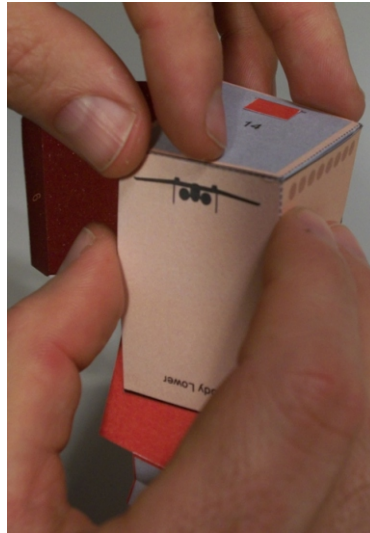

● Form Corners of Bottom (7).

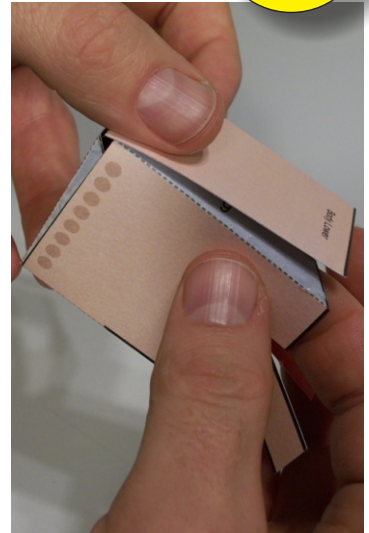

● Form Side of Bottom (6).

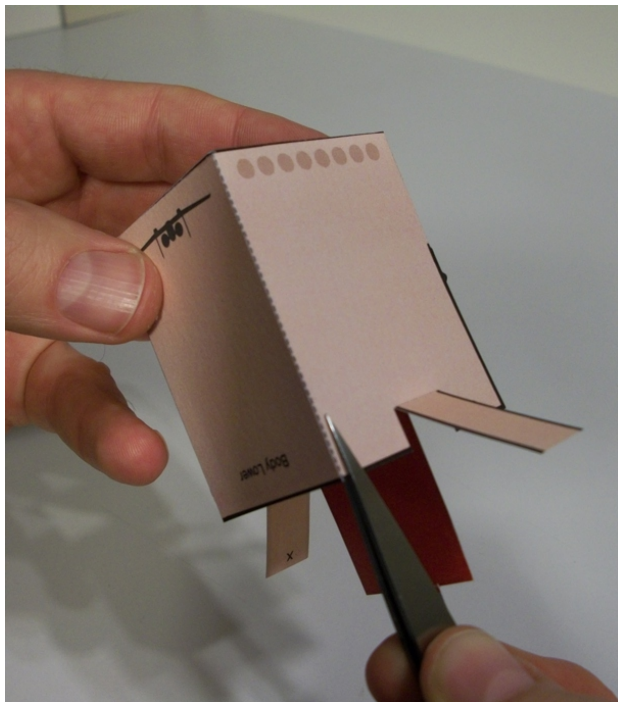

● Use Tweezers to pinch glued joints together.

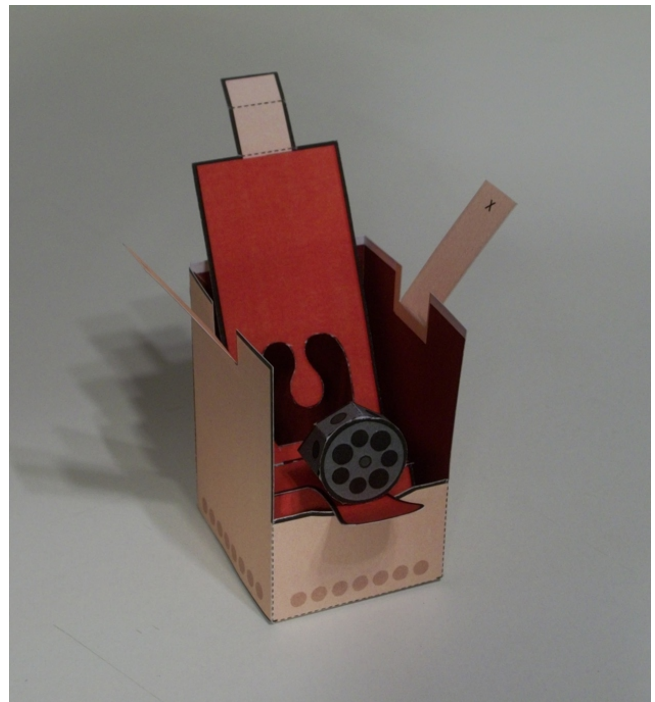

● Completed Body-Bottom.

Assembly : 6 - Top of Body

Attach Teeth; Crease, Wrap, & Glue Body-Top; Bend Arm Pit Bottoms.

6

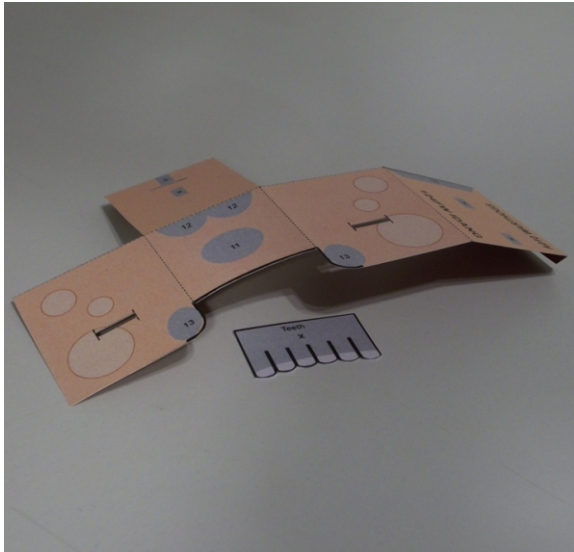

● Crease Body Top & Ready for Teeth

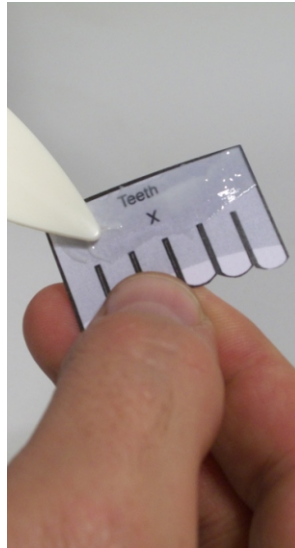

● Glue Teeth.

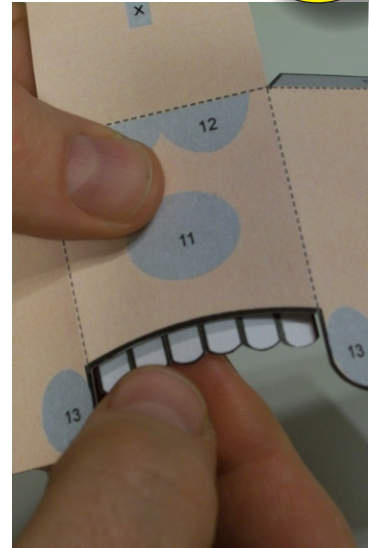

● Attach Teeth to Body-Top.

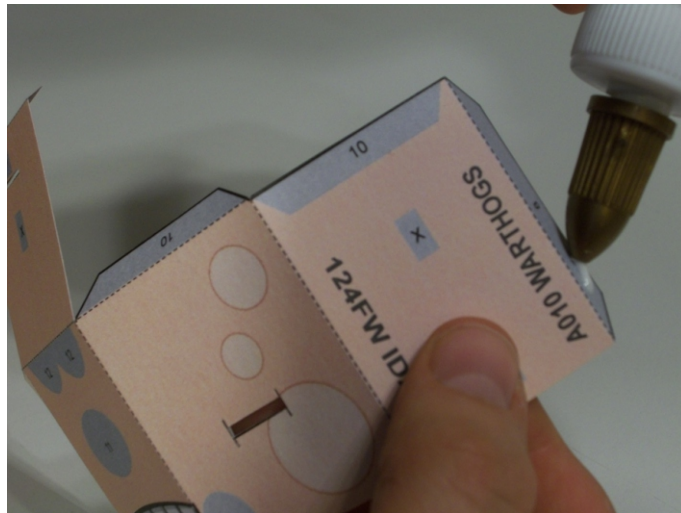

● Glue and Wrap Body-Top (Tab 8).

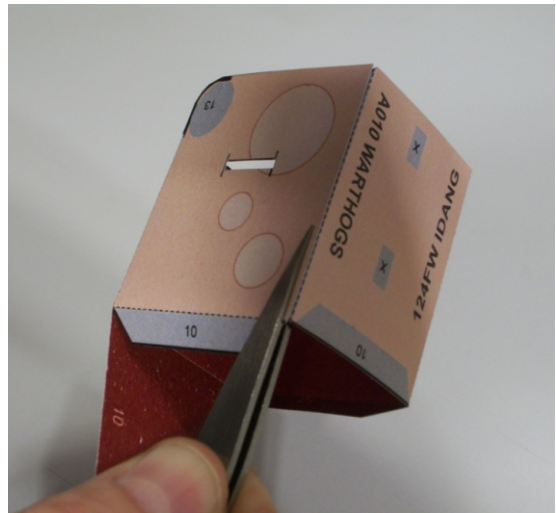

● Pinch Glued Joint with Tweezers.

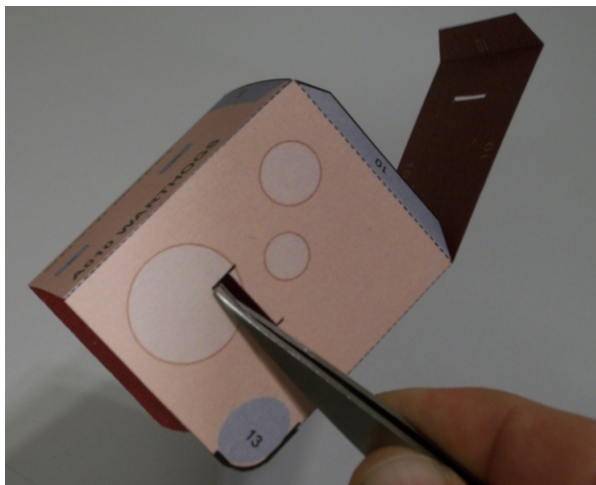

● Use Tweezers to Bend Down Bottom of Arm Pits.

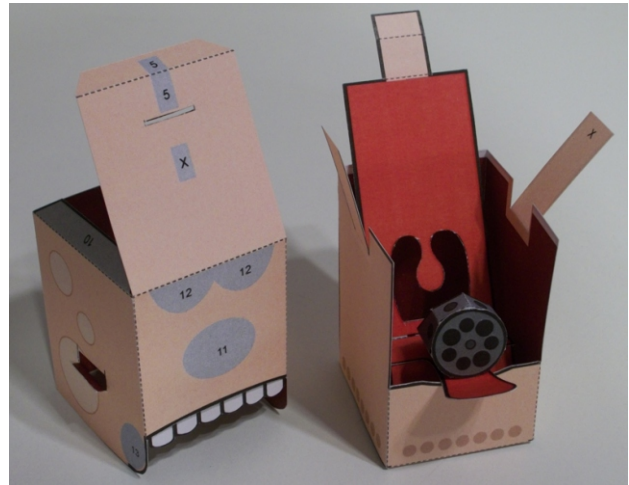

● Completed Bottom & Top Sections of Body.

Assembly : 7 - Body

Assemble Body, Bend Upper Arm Pits, Form Teeth.

7

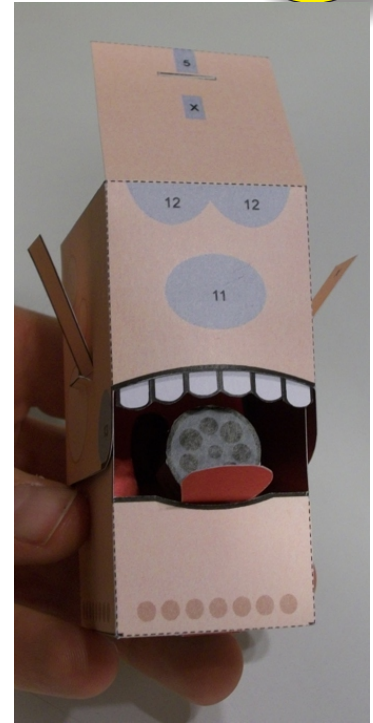
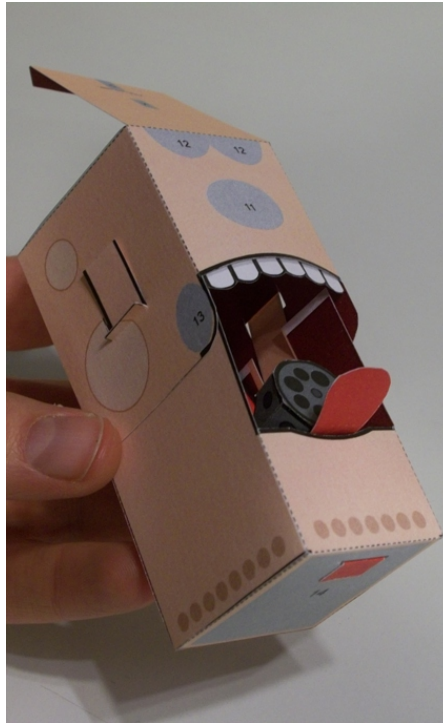
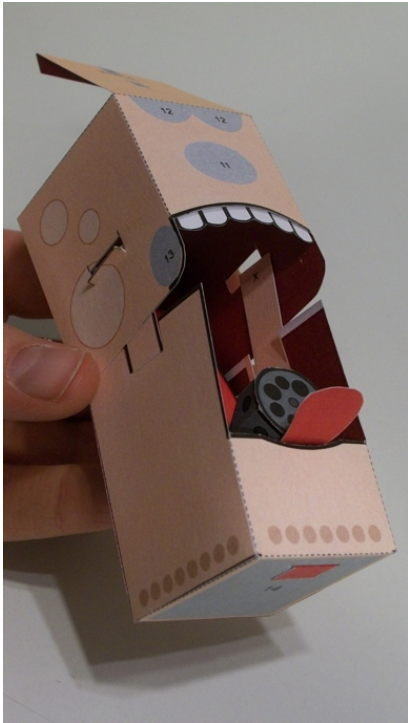

- Weave Arms through Arm Pits, assembling two halves of Body.

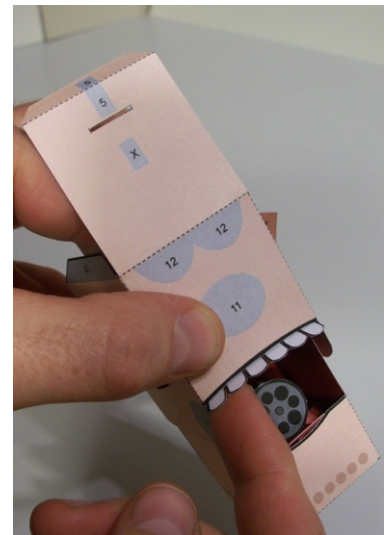
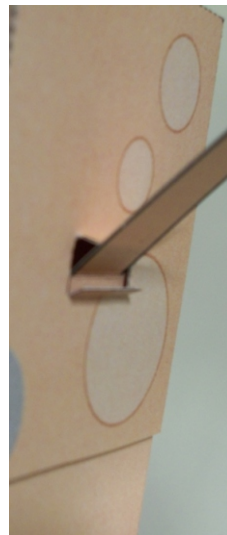
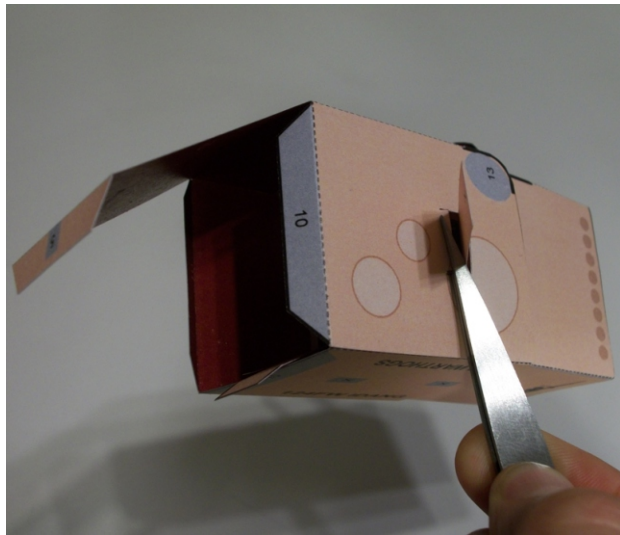

- Bend out Upper Arm Pits to Better Allow Movement.

- Finished Arm Pits.

- Bend Out Teeth to Form.

Assembly : 8 - Complete Main Body & Test

Assemble Body, Bend Upper Arm Pits, Form Teeth; Test Movement.

8

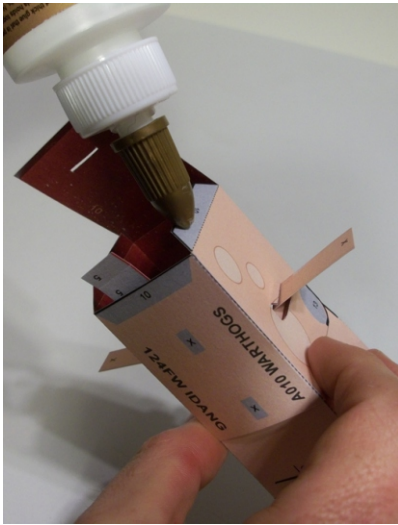

● Glue Body-Top Joint Surfaces.

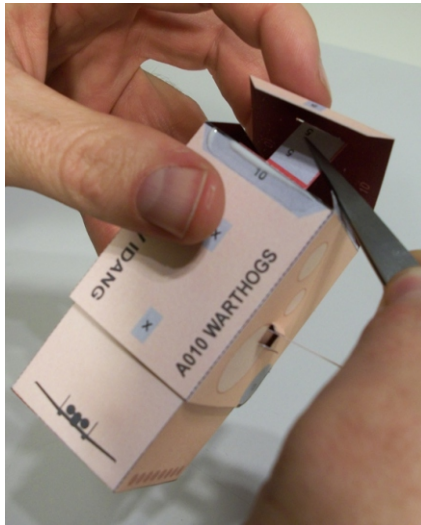

● Carefully Thread Throat Tab (5) Through Top.

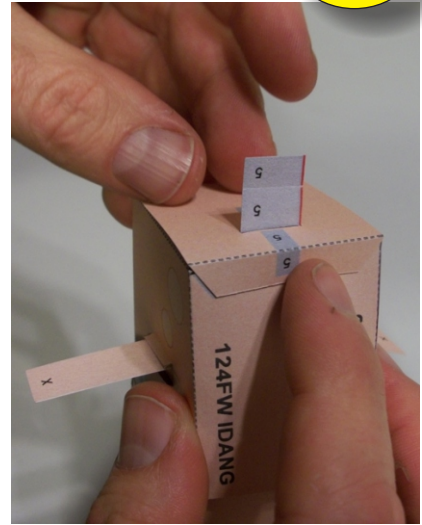

● Glue Down Body-Top.

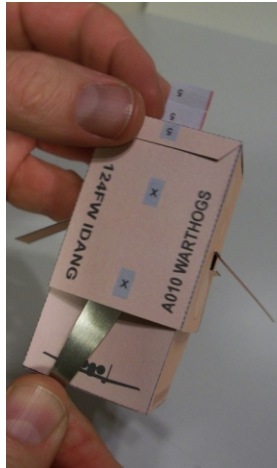

● Taking Care to Keep Top Tab Threaded, Fasten Down Glued Surfaces with Tweezers.

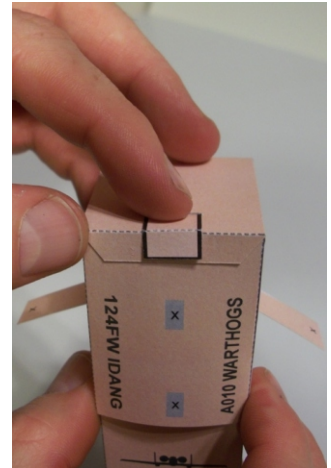
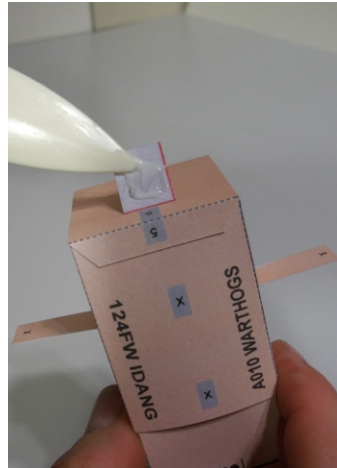
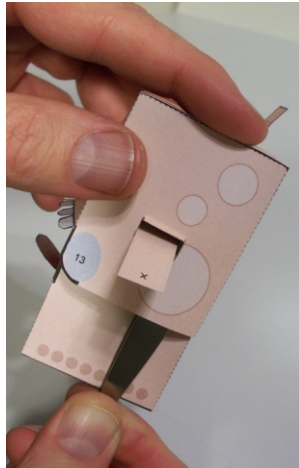

● Glue Down Tab (5) to Top.

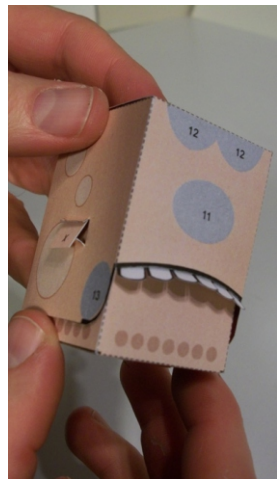

● Main Body Complete.

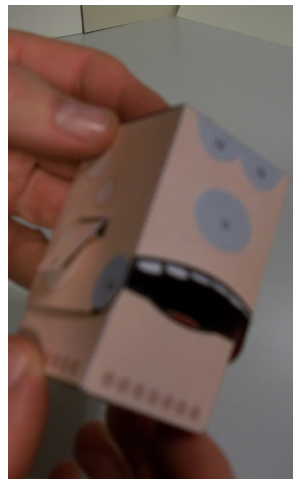

● Test Full Function and Movement.

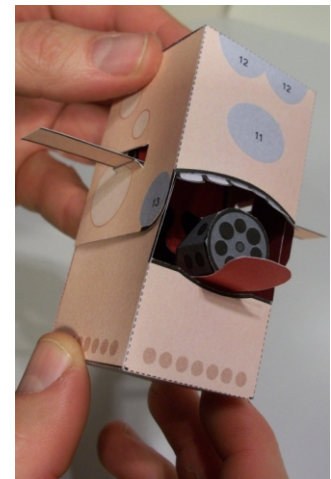
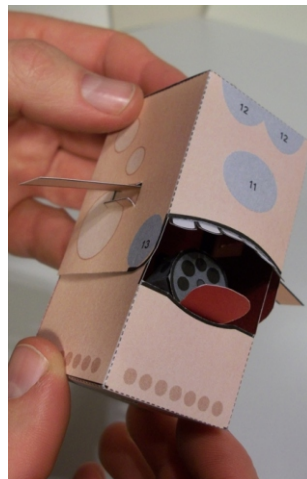

Assembly : 9 - Embellishments

Attach all additional body parts to main body.

9

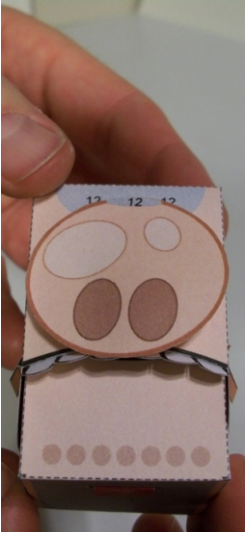

● Glue Nose to Front.



● Glue Eyes to Top of Nose.

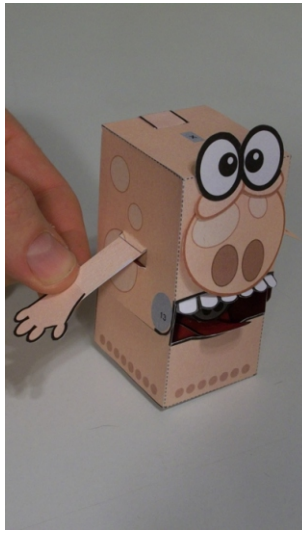

● Attach Hands to Arms.

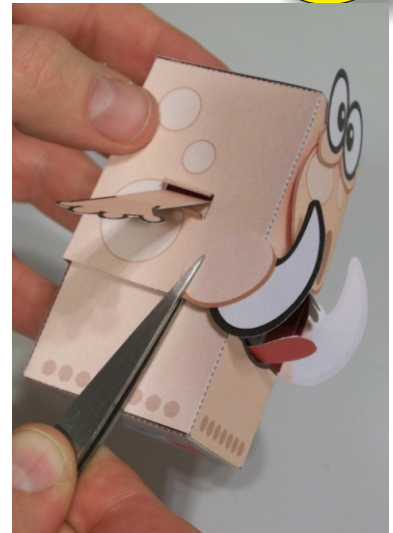

● Glue Tusks to Cheeks.

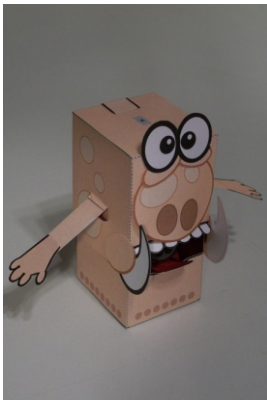

● Next, Bend Out Tabs on Tail Sides, Glue Together Both Sides, Then Glue Tail to Body Back and Pinch Down with Tweezers.

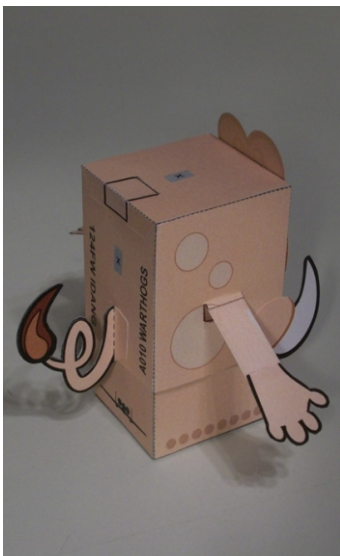
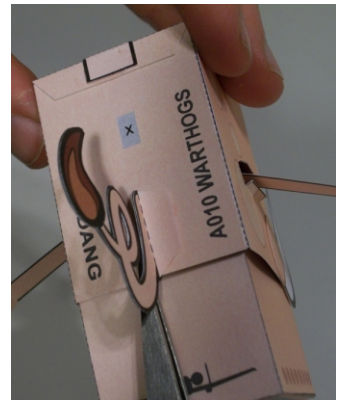
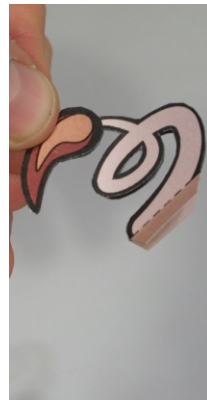

● Next, do the same with the Hair.

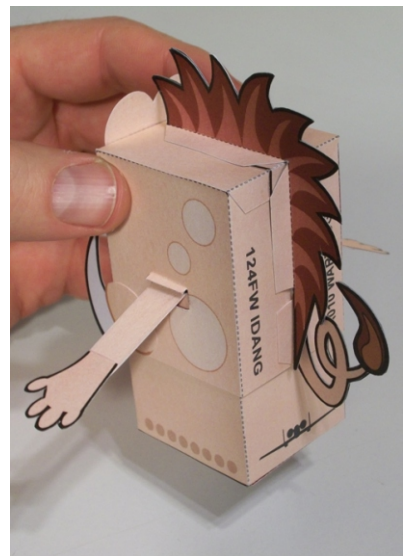
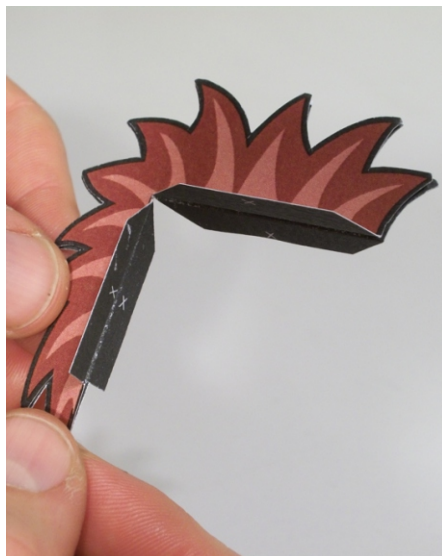

Assembly : 9 - Embellishments (Continued...)

Attach all additional body parts to main body.

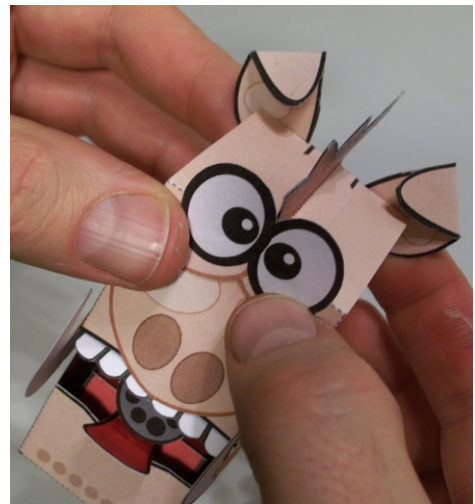
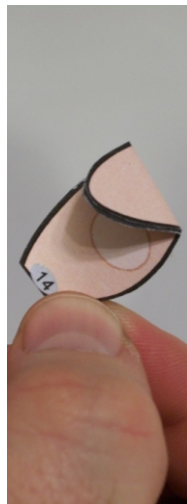
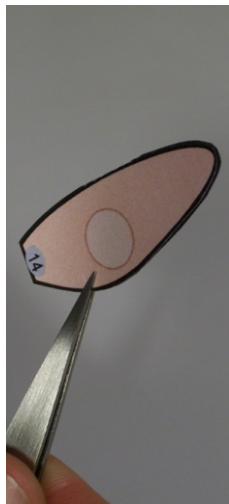
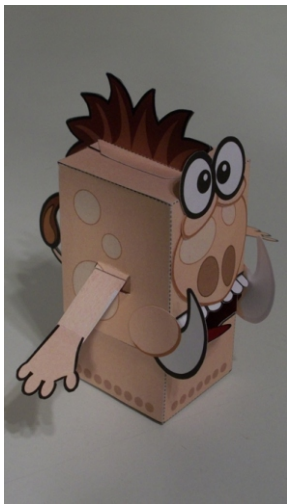

- Ears: Next, Glue & Fold Ears. Then, Fold Tips of Ears and Attach them to the Top and Back of Body at an angle.

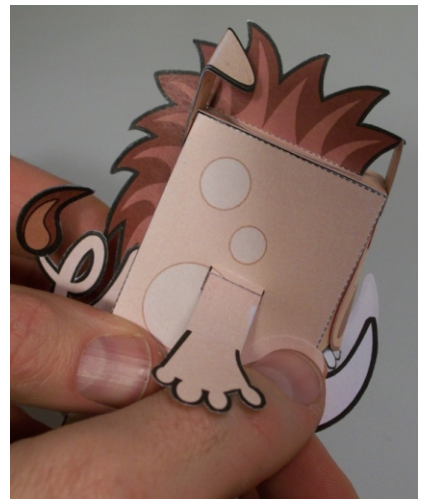

- Form: Next, Curve Tail and Bend out Tusks to give the warthog more appealing form.

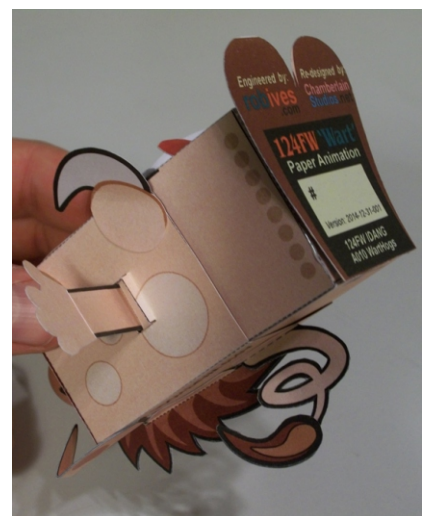
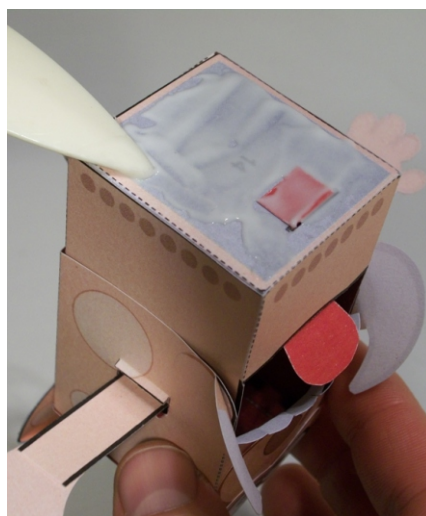
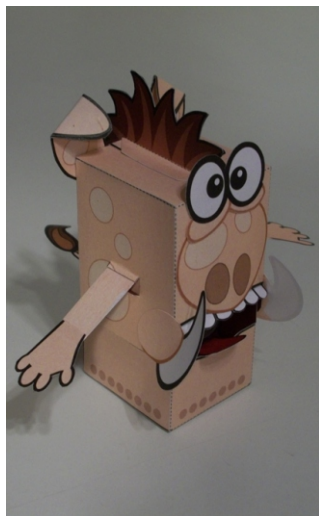

- Feet: Lastly, Glue Feet to bottom of Body.

Complete

Allow Glue to Cure and Test, making final Adjustments as necessary.

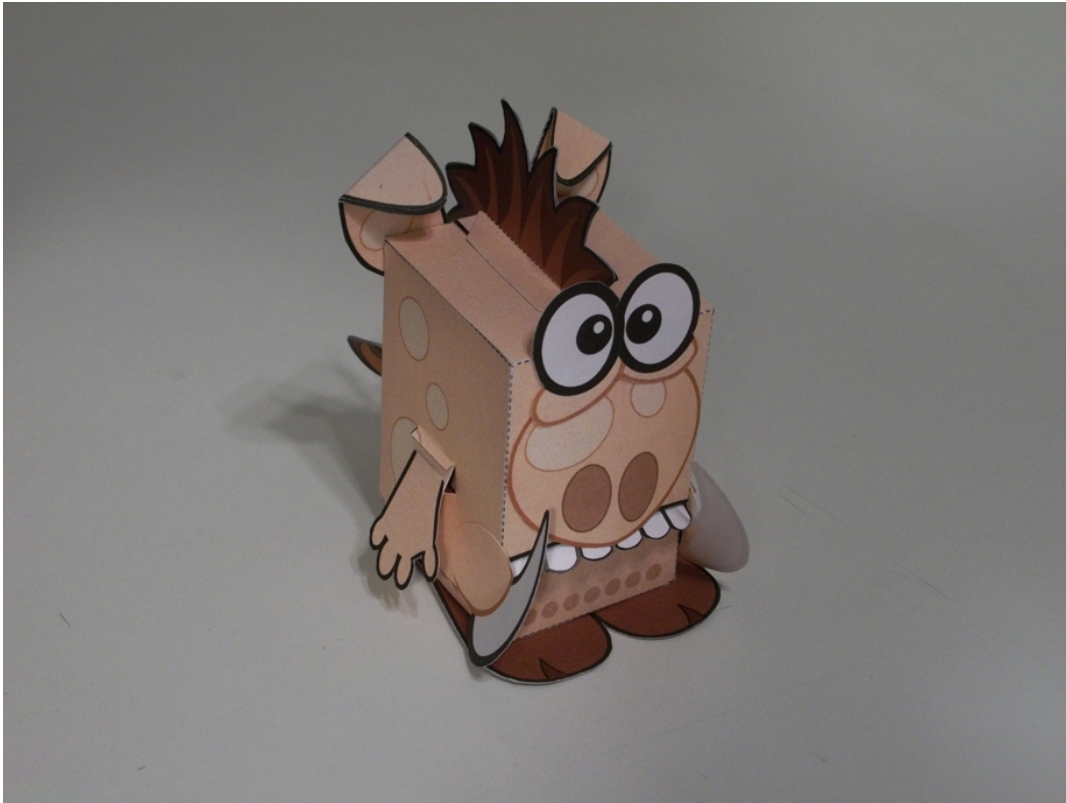

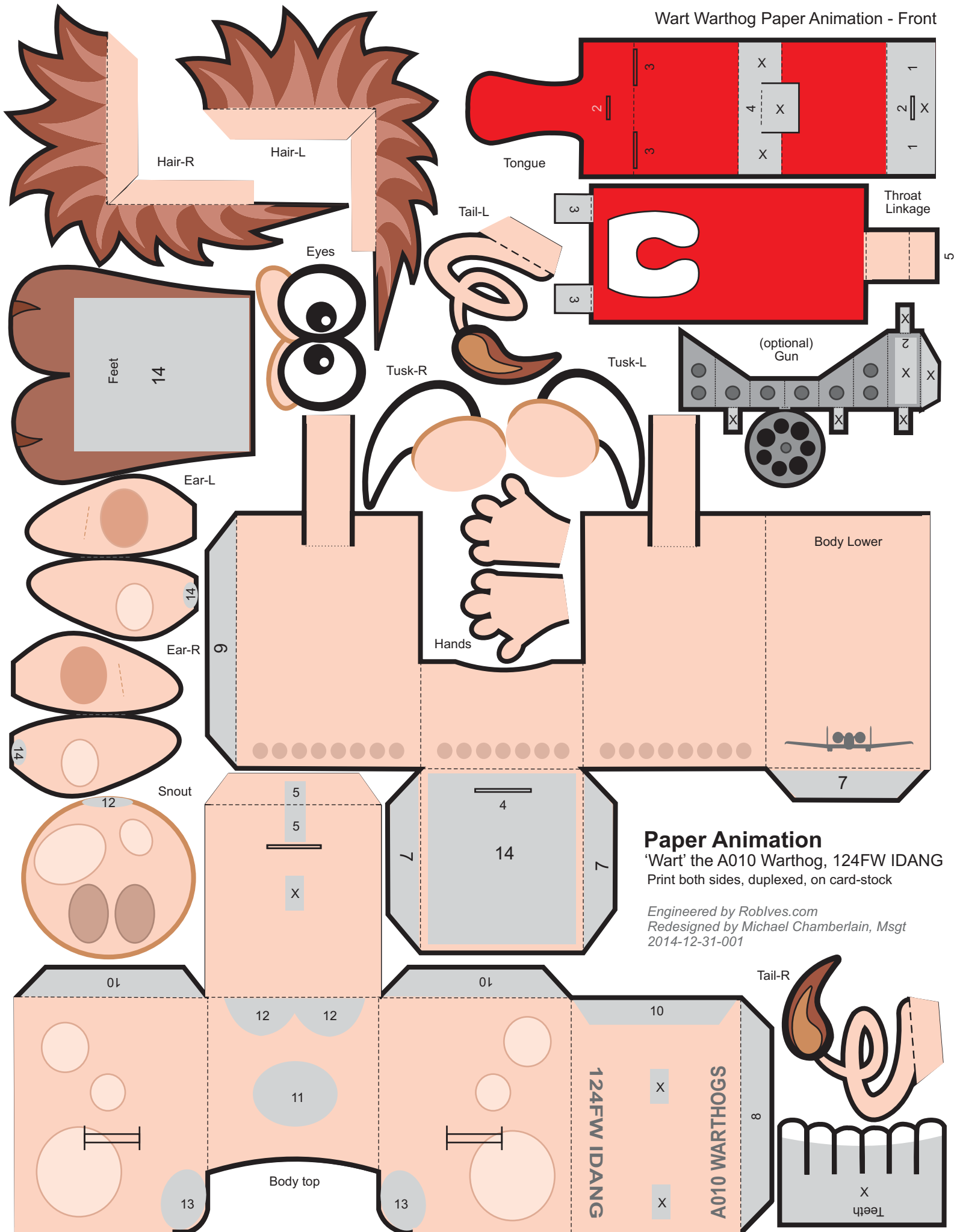

Paper Animation

'Wart' the A010 Warthog, 124FW IDANG

Print both sides, duplexed, on card-stock

Engineered by Roblves.com

Redesigned by Michael Chamberlain, Msgt

2014-12-31-001

Re-designed by:
**Chamberlain
Studios.net**

124FW 'Wart'

Paper Animation

#

Version: 2014-12-31-001

124FW IDANG
A010 Warthogs

Teeth
X